

Collimated Red Laser Diode

Part No: **COL-XXG-635A**

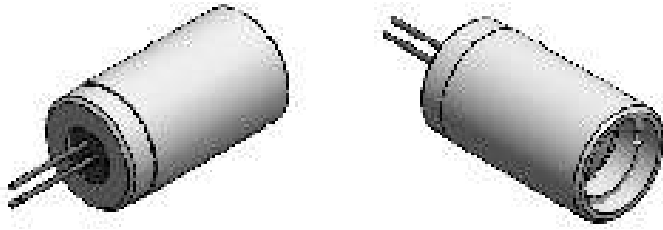

Product Features

- Collimated Beam with Aspherical Glass Lens
- Small Black Anodized Aluminum Package

Applications

- Measurement
- Automation
- Alignment

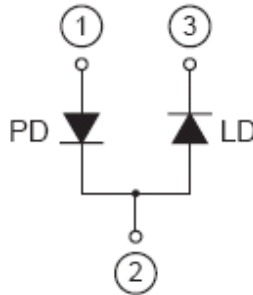
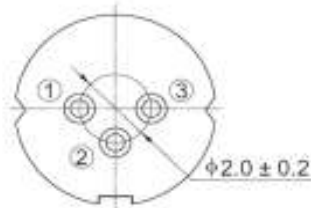

Specifications

OPTICAL

Wavelength, nm	635 -0/+5 nm
Optical Power, mW	7, 10, 20
Polarization orientation	long axis
Laser Stability	N/A
Beam	Elliptical
Beam Spot Size	Adjustable, Collimated 5 mm x 2 mm
Beam Divergence	< 0.8 mrad collimated
Wavelength Drift	0.2 nm/K

ELECTRICAL

Operating Voltage	2.2 V
Operating Current	Depends on Power
Maximum Operating Current	Depends on Power
Monitoring PD Current	0.2 mA

MECHANICAL

Dimension	8 mm D x 15 mm L
Operating Temperature	+10°C to +70°C
Storage Temperature	-40°C to +80°C



Operational Hazard-Semiconductor Laser Diode Module:

This laser module emits radiation that is visible/invisible and harmful to human eye. When in use, do not look directly into the laser emitting aperture.

Direct viewing of laser diode emission at close range may cause eye damage.

Collimated red laser diode module is sold solely for use in OEM equipments.

OEM is responsible for compliance with all applicable safety regulations and standards.

World Star Tech.

185 Konrad Crescent, Markham, ON L3R 8T9 Canada
Tel: (416) 363-3332 Fax: (416) 363-3112 www.worldstartech.com



ISO9001:2000 Registered